

## 0.75M KA/KU-Band Manual Flyaway Antenna



### General Specification:

The Probecom 0.75m offset manual flyaway antenna is specially designed for highly portable antenna by adopting carbon fiber material with light weight and can be assembled in less than 3 minutes by one person . It can provide users exceptional performance in high gain and low side lobe

### Highlight Features:

- Carbon fiber antenna reflector with light weight, high precision and high efficiency, corrosion resistance and other characteristics, it ensured the antenna in the normal operation under harsh environment in greatest degree.
- Compact structure, Lightweight, portable, rapid deployment, high performance, a person can install and point to satellite within 5 minutes, available in airline baggage.
- Designed specifically for field use, regardless of when and where, it can quickly transfer high-quality broadband content.

### Applications:

- Sudden public events and all kinds of disasters on-site information gathering Disaster relief.
- Public security, military, government, oil, water conservancy, electricity, finance and other important sectors of the country
- The remote areas and the vast rural areas out of coverage. Field operations, exploration, military police and news media.

### Components:

- Single Offset Antenna
- Azimuth & elevation turntable
- Portable backpack

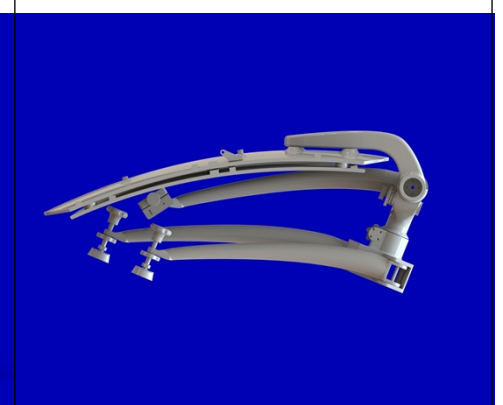

# Technical Specification

Electrical Specification				
Type	Ka-Band		Ku-Band	
	RX	TX	RX	TX
Operating Frequency (GHz)	17.7-21.2	27.5-31.0	10.7-12.75	13.75-14.5
Gain, mid-band (dBi)	41.7@20.0GHz	45.2@30.0GHz	37.2@12.0GHz	38.6@14.0GHz
Polarization	Circular		Linear	
Axis Ratio	1.5dB	1.5dB	/	
VSWR	1.3:1	1.3:1	1.3:1	1.3:1
-3 dB Beam Width, Mid-band	1.33°	0.90°	2.25°	1.92°
Tx to RX isolation	85dB		80dB	
Cross-polarization isolation	/		35dB	
Sidelobe	CCIR 580-5		CCIR 580-5	
Tx. Power Capability	/	100W	/	200W
Feed Interface	WR42	WR28	WR75	WR75
Feed Insertion Loss	0.3dB	0.3dB	0.2dB	0.2dB
Mechanical Specifications				
Antenna Type	Single offset			
Main Reflector	Carbon Fiber			
Feed	Ku/Ka Quick feed swap			
Weight	≤9Kg			
Deploy/Stow	3 minutes			
Operating Wind	Stable wind≤50km/h; gusting≤65km/h (need increase weight)			
Operating Temperature	-40°C~+55°C			
Storage Temperature	-55°C~+80°C			
Drive Mode	Manual			
Azimuth Travel	360°			
Elevation Travel	0°~90°			
Surface Accuracy (R.M.S)	0.2mm			
Relative Humidity	0%~100%			